

HARDWARE KITS:

| NO. | DESCRIPTION | QTY |
|------------|------------------------|------------|
| 1 | M5*8 C'SINK SCREWS | 9 |
| 2 | ST4*25 C'SINK SCREWS | 5 |
| 3 | ST5*32 C'SINK SCREWS | 5 |
| 4 | BRACKETS (SH2500-06) | 2 |
| 5 | M4 * 9.5 C'SINK SCREWS | 9 |
| 6 | Flat washers | 5 |
| 7 | BRACKETS (SH2500-07) | 2 |

iGES 2500

INSTALLATION

ANOTHER QUALITY PRODUCT

GENERAL INFORMATION

1. Before mounting an electromagnet, please make sure that all the security requirements are followed.
2. Electromagnets are used for security access so they must be mounted in such a way that it resist shocks when the door is closed and from attempted break-ins.
3. An electromagnet should always be mounted on the secured side of the access.

Part list:

| | |
|-------------------|--------------------------|
| 1 x Lock Body | 1 x Armature Plate |
| 1 x PCB Set | 1 x LED |
| 1 x Hardware Kits | 1 x Manual instructions. |

Ratings:

| | |
|----------------|----------------|
| Holding Force: | 7500N in shear |
| Input power: | 12V DC/24V DC |
| Rush: | 1.0 amp/0.5amp |
| Normal: | 0.2 amp/0.1amp |
| Relay: | 1A/24VDC |

WIRING DETAILS

Typical Wiring

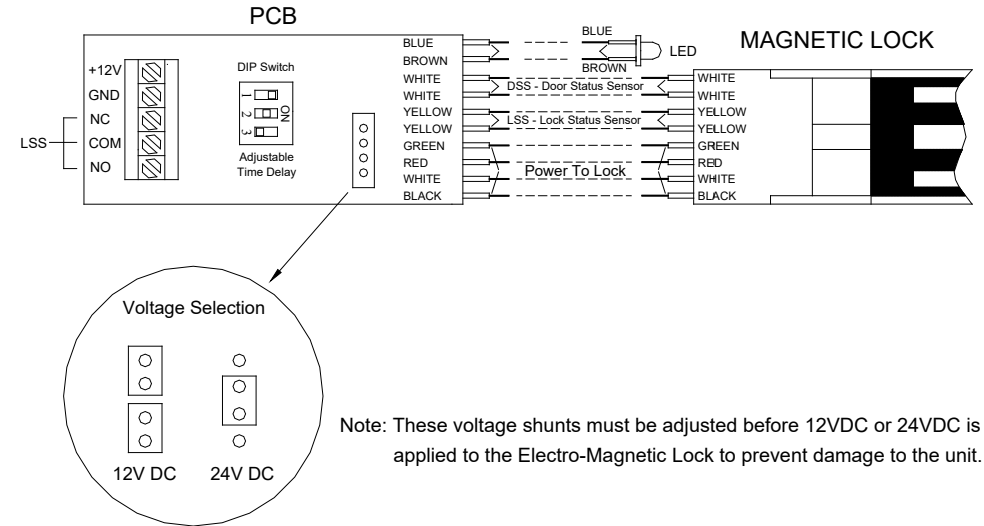

Adjustable Time Delay, LED & Lock Status Sensor

1. The adjustable time delay can be set to delay unlock time from 0 to 6 seconds.

| | | | | | | | |
|-----------------|---|---|---|-----|-----|-------|-----------|
| DIP Switch(on) | 1 | 2 | 3 | 1&3 | 2&3 | 1&2&3 | 1&2&3 off |
| Delay time(sec) | 1 | 2 | 3 | 4 | 5 | 6 | 0 |

2. The LED's indicator indicates lock status.

| | | |
|-----------|-----------------------|---------------------|
| LED off | LED blinking | LED on |
| Door open | Locked unsuccessfully | Locked successfully |

3. The Lock Status Sensor outputs C, NC & NO indicates door locked or unlocked. C & NC conducted – Unlocked. C & NO conducted – Locked.

TYPICAL MOUNTING ON WOODEN DOOR

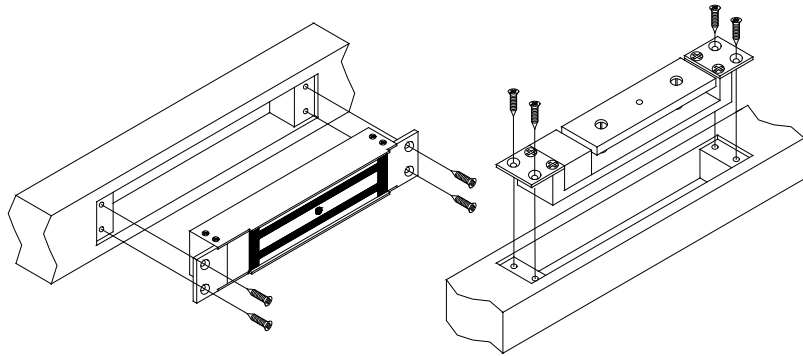

METALLIC OR PVC DOOR

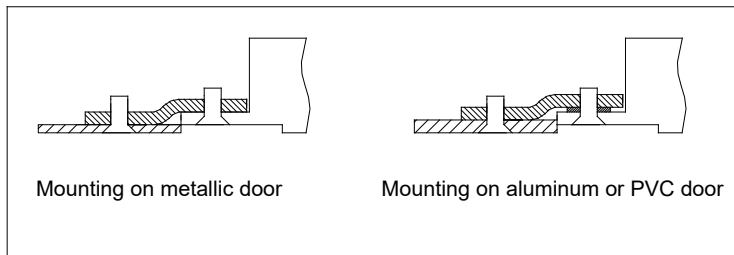
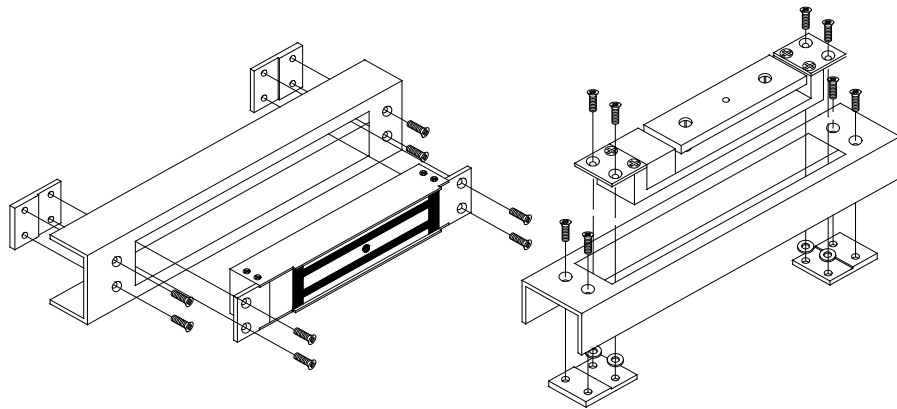

MOUNTING DIMENSION

Mounting on Metallic, Aluminum or PVC door (Lock body and armature plate)

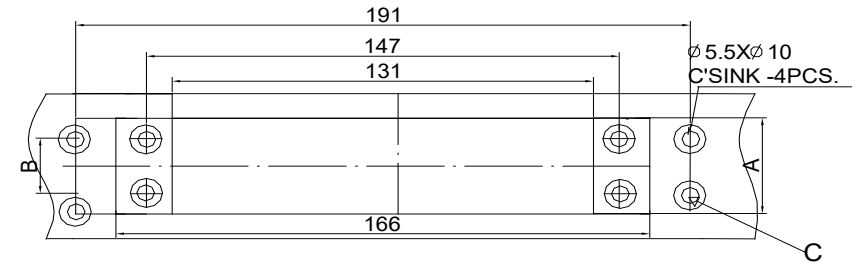

A=32mm (Lock Body) A= 27mm (Ar nat ure Pl ate)
 B=19mm (Lock Body) B= 14mm (Ar nat ure Pl ate)
 C=Ø5.5 XØ10 X90° (Lock Body) C= Ø4.5 X Ø8 X90° (Ar nat ure Pl ate)

Mounting on Wooden Door (Lock Body)

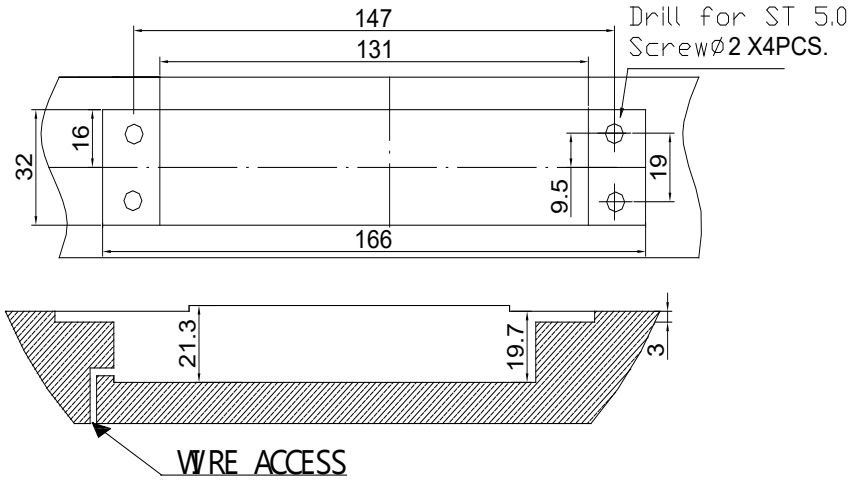

-5-

ADJUST AFTER MOUNTING

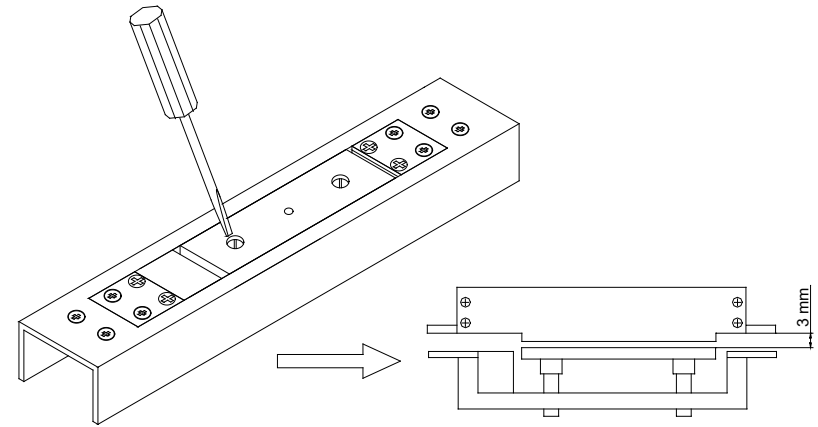

After mounting, adjust the adjusting screws to make sure the gap is 3mm .

Mounting on Wooden Door (Armature Plate)

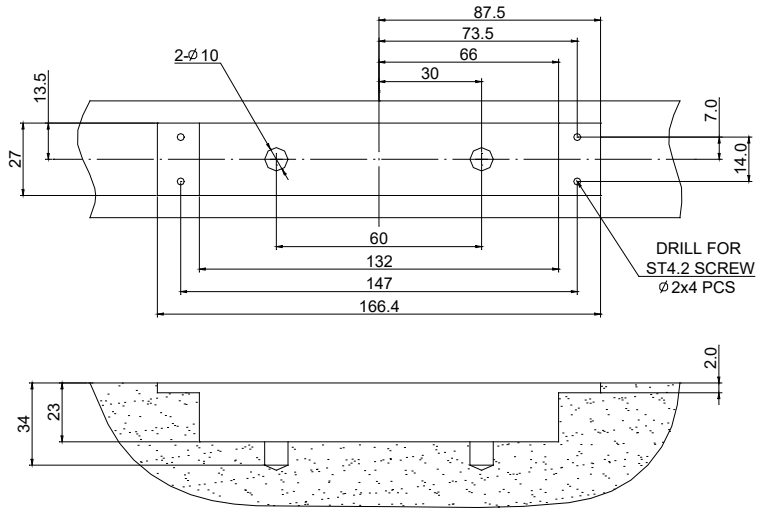

APPARENTNESS OF iGES 2500

